

W:\WP-SEVEN\Projects\142486\142486.dwg - Phase 1 TREE PRESERVATION PLANNING - 2 Dec 12, 2024 - 1:45pm Jason Logsdon

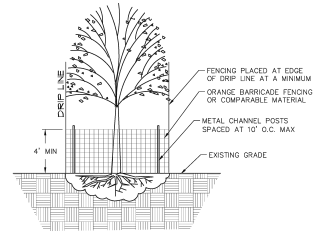

- NOTES:
- EXISTING TREES AND THEIR ROOT ZONES THAT ARE TO BE SAVED MUST BE PROTECTED FROM ALL CONSTRUCTION ACTIVITIES INCLUDING, BUT NOT LIMITED TO, EARTHWORK OPERATIONS, MOVEMENT AND STORAGE OF EQUIPMENT AND VEHICLES, AND PLACEMENT OF CONSTRUCTION MATERIALS AND DEBRIS.
  - TREE PROTECTION FENCING MUST BE PLACED AROUND ALL TREES OR WOODED AREAS TO BE PROTECTED PRIOR TO ANY CONSTRUCTION ACTIVITY, AND REMAIN ERECT AND SECURE THROUGHOUT ALL CONSTRUCTION PHASES.

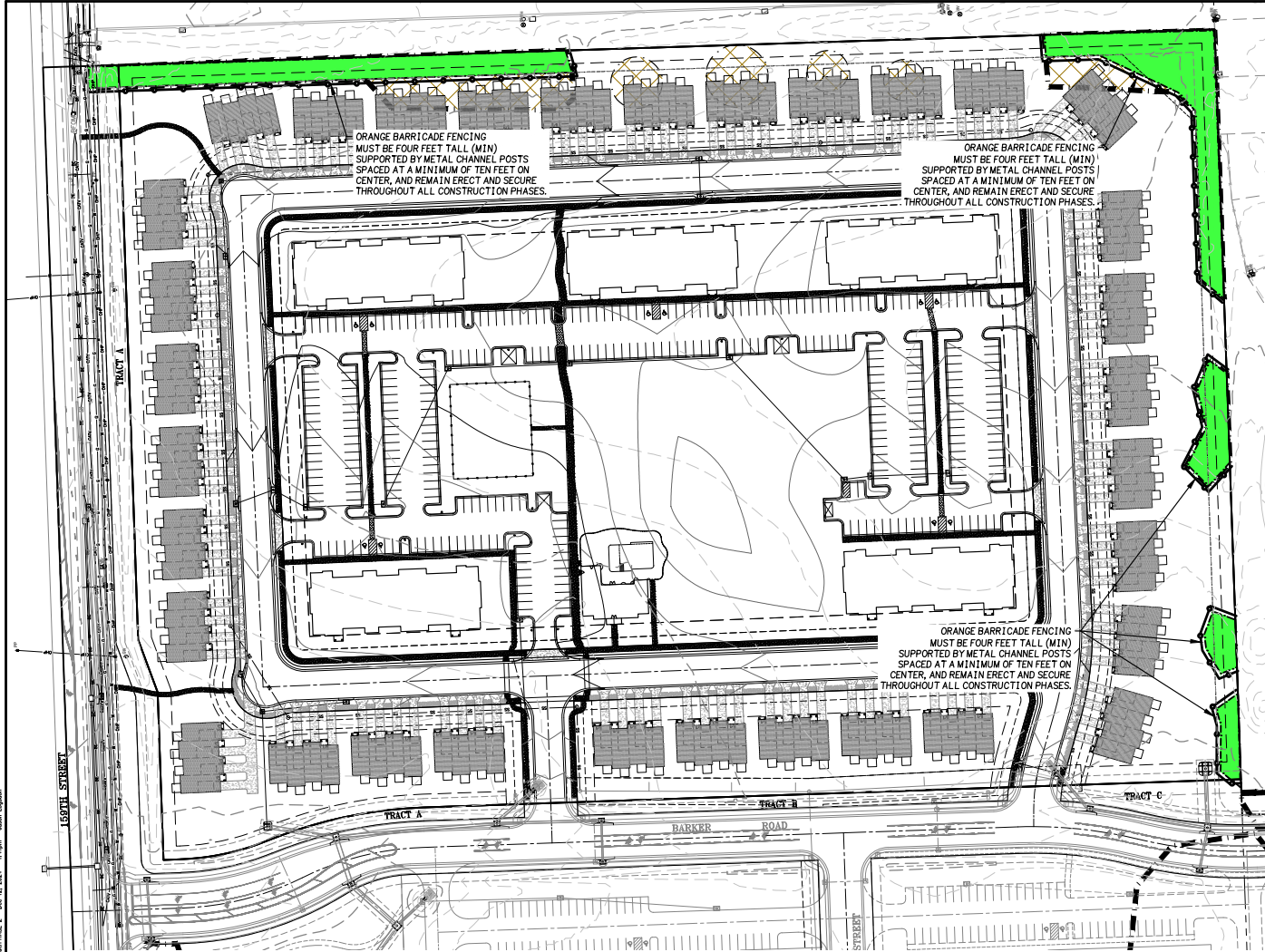

SCALE: 1" = 60'  
0 60 120'

- NOTE:  
 THE REQUIRED TREE PROTECTION FENCING MUST BE INSTALLED AND PASS CITY INSPECTION PER 100' SECTION 14.30.200 PRIOR TO ALL CONSTRUCTION ACTIVITIES, SUCH AS EXCAVATING, GRADING, CONSTRUCTION, OR TREE REMOVAL.
- LEGEND:
- 1044 — EXISTING CONTOUR
  - 1044 — PROPOSED CONTOUR
  - TREES PRESERVED
  - TREE REMOVAL AREA
  - ORANGE CONSTRUCTION FENCE

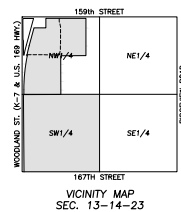

**R1 - R3 TREE PRESERVATION SUMMARY PHASE II**

TOTAL AREA OF TREE CANOPY	1.2 AC.
20% OF TREE CANOPY AREA	0.2 AC.
AREA OF TREES PRESERVED	0.8 AC.
% OF TREES PRESERVED	67%
REQUIRED	ACTUAL
TOTAL 0.2 Ac. (20%)	0.8 Ac (67%)

PREPARED BY: JASON LOGSDON  
 CHECKED BY: JASON LOGSDON  
 DATE: JAN 2024  
 APPROVED: JASON LOGSDON

TREE PRESERVATION  
 OLATHE

PROFESSIONAL ENGINEER  
 STATE OF KANSAS  
 LICENSE NO. 17241  
 JASON LOGSDON

PROJECT INFORMATION: INC  
 1501 W. 169th Street  
 Olathe, MO 66045  
 www.logsdoninc.com

KANSAS PROFESSIONAL ENGINEERING BOARD  
 PEI

**TREE PRESERVATION PLAN PHASE II**  
 PARK 169, SECOND PLAT  
 OLATHE, KANSAS

No.	Date	Revised	By