

PLANT SCHEDULE

CODE	BOTANICAL / COMMON NAME	SIZE	CONTAINER	QTY	DETAIL
DECIDUOUS TREES					
ACE CDD	Acer saccharum 'Caddo' / Caddo Sugar Maple	2.5" Cal.	B&B	6	1L103
NYS SYL	Nyssa sylvatica / Tupelo	2.5" Cal.	B&B	4	1L103
QUE RUB	Quercus rubra / Northern Red Oak	2.5" Cal.	B&B	4	1L103
TAX DIS	Taxodium distichum / Bald Cypress	2.5" Cal.	B&B	4	1L103
EVERGREEN TREES					
CEC BLO	Cedrus atlantica 'Glaucia' / Blue Atlas Cedar	6" Ht.	B&B	2	1L103
JUN SK2	Juniperus scopulorum 'Skyrocket' / Skyrocket Juniper	6" Ht.	B&B	20	1L103
JUN EAS	Juniperus virginiana / Eastern Redcedar	6" Ht.	B&B	2	1L103
PIC ABB	Picea alberta / Norway Spruce	6" Ht.	B&B	1	1L103
PIC G22	Picea pungens 'Glaucia' / Blue Colorado Spruce	6" Ht.	B&B	9	1L103
FRUIT TREES					
MAL MN2	Malus x 'MN 1711' / Honeycrisp Apple	2.5" Cal.	B&B	1	1L103
PRU BNG	Prunus avium 'Bing' / Bing Sweet Cherry	2.5" Cal.	B&B	1	1L103
PRU CTN	Prunus persica 'Contender' / Contender Peach	2.5" Cal.	B&B	3	1L103
ORNAMENTAL TREE					
ACE BLO	Acer palmatum 'Bloodgood' / Bloodgood Japanese Maple	2" Cal.	B&B	2	1L103
CER OKL	Cercis canadensis texensis 'Oklahoma' / Oklahoma Texas Redbud	2.5" Cal.	B&B	12	1L103
MAL RAD	Malus x 'Radiant' / Radiant Crabapple	2.5" Cal.	B&B	2	1L103
SHRUBS					
BUX WGM	Buxus microphylla japonica 'Winter Gem' / Winter Gem Japanese Boxwood	5 gal.	Pot	38	32
COR ZAG	Cornephor verticillata 'Zagreb' / Zagreb Tickseed	2 gal.	Pot	38	32
COR ALL	Cornus sericea 'Marian's Compact' / Dwarf Red Twig Dogwood	5" Ht.	Pot	15	32
ECH MAG	Echinacea purpurea 'Magnus' / Magnus Purple Coneflower	2 gal.	Pot	8	32
FOR LYN	Forsthia x intermedia 'Lynwood Gold' / Lynwood Gold Forsythia	3 gal.	B&B	29	32
HYD OAK	Hydrangea quercifolia 'Snow Queen' / Snow Queen Oakleaf Hydrangea	3 gal.	B&B	42	32
JUN MOO	Juniperus sabina 'Monsieur' / Moor-Cressel Juniper	3 gal.	Pot	64	32
LIR SUN	Liriodendron muscari 'Silvery Sunroof' / Silvery Sunroof Lilyturf	1 gal.	Pot	37	32
NEP WLO	Nepeta x 'Walker's Low' / Walker's Low Catmint	3 gal.	B&B	16	32
PHY BRU	Physocarpus opulifolius 'POPRIZ' / Petite Plum Ninebark	3 gal.	B&B	84	32
SAL MA2	Salvia nemorosa 'May Night' / May Night Meadow Sage	2 gal.	Pot	31	32
SCH LIT	Schizanthus litoralis / Little Bluestem	2 gal.	Pot	17	32
SPO HET	Sporobolus heterolepis / Prairie Dropseed	2 gal.	Pot	61	32
SYR MEY	Syringa meyeri 'Palibin' / Dwarf Korean Lilac	3 gal.	Pot	514	32
SYMBOL CODE					
SHRUB AREAS					
VIN CO3	Vincetoxicum minor 'Bowles' / Bowles Periwinkle	1 gal.	Pot	18" o.c.	84
GROUND COVERS					
VIN CO3	Vincetoxicum minor 'Bowles' / Bowles Periwinkle	1 gal.	Pot	12" o.c.	377
SOD/SEED					
TUR LIS	KANSAS PREMIUM FESCUE BLEND- SEED	seed			43,078 sf
TUR GOU	KANSAS PREMIUM FESCUE BLEND- SOD / Fescue Blend including Blue Grass	sod			19,448 sf
REFERENCE NOTES SCHEDULE					
Rock					
K-101	BOULDER- GRANITE SIZE- 24" X 36"				
K-102	BOULDER- GRANITE SIZE 12"x12"				
K-103	STONE GRADATION MIX AS FOLLOWS: 6"-12" STONES SHALL BE ROUNDED NATURAL RIVER ROCK. PLACE NON-WOVEN GEOTEXTILE FABRIC BELOW ROCK	4L103	6-12"x6"		
MIX SIZE: Stone Size Percent of Mix Notes 6-12 in 20-30% Larger stones for structural stability 3-6 in 10-20% Medium stones for interlocking 1-3 in 10-20% Smaller stones fill voids, improve infiltration 0.5-1 in 10-15% Optional fine gravel for bedding/filtration					
CODE DESCRIPTION					
Site Furnishings					
S-101	STEEL EDGING- ALUMINUM			3L103	

SITE PLANTING PLAN

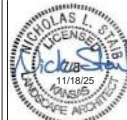
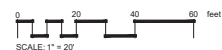

Kansas Code Plans LLC.
2627 N. Beacon Hill Ct
Wichita, KS 67220
T 316.393.8576
KansasCodePlans.com

SOLOMON'S PORCH ASSISTED LIVING

16560 W INDIAN CREEK PKWY.
OLATHE, KS 66062

SLA STUDIO
Landscape Architecture
316.304.1720 4303 N. CIMARRON STREET, WICHITA, KS 67205

PRINTS ISSUED
10/27/25 FOR APPLICATION

REV.
NO. DATE DESC.
11/18/25 PLAN REVIEW COMMENTS

SLA No. 25-2005
drawn: NS
checked: NS

SITE PLANTING PLAN

L101

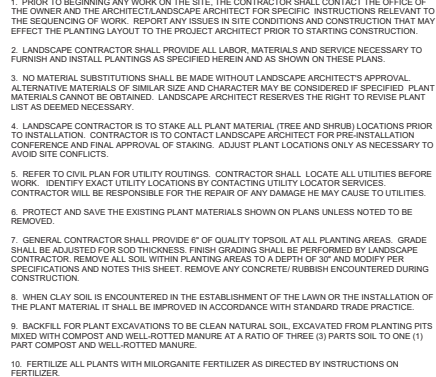

URBAN TREE FOUNDATION © 2014
OPEN SOURCE FILE TO USER

[illegible]

Kansas Code Plans LLC
2627 N Beacon Hill Ct
Wichita, KS 67220
T 316.393.8576
KansasCodePlans.com

 $1/2^{\circ} = 1'-0"$ 

FX-PLNT-FX-TRSE-2



THE SITE WILL BE REZONED AS C1, VERTICAL RESIDENTIAL

STUDIO Landscape Architecture
316.304.1720 4303 N. CIMARRON STREET, WICHITA KS 67205

REVS.		
NO.	DATE	DESC.
1	11/18/25	PLAN REVIEW COMMENT

SLA No. drawn: NS
25-2005 checked: NS
 PLANTING NOTES AND
 DETAILS

L102

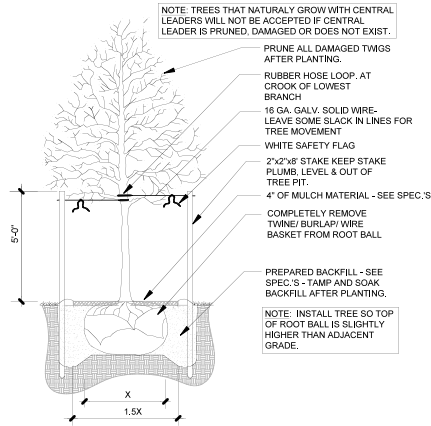

1 TREE PLANTING DETAIL

3/8" = 1'-0"

329343-01

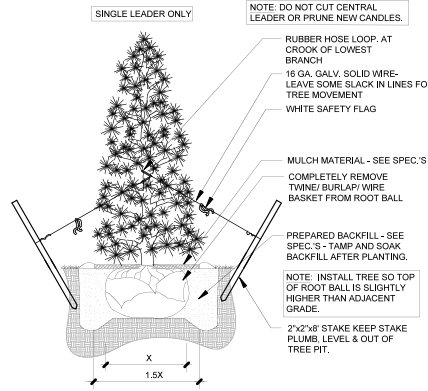

2 CONIFER PLANTING DETAIL

3/8" = 1'-0"

329343-02

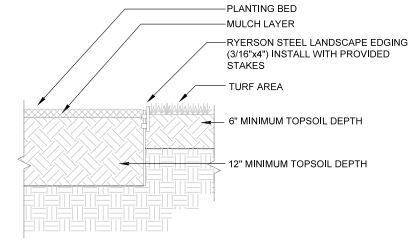

3 STEEL EDGING DETAIL

3/8" = 1'-0"

329413-01

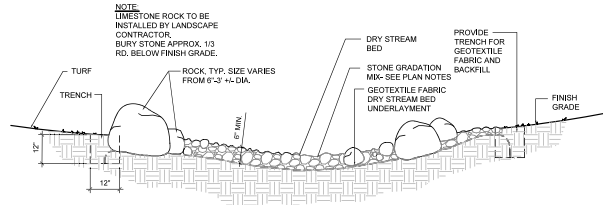

SCALE: 1/2"=1'-0"

4 DRY STREAM BED DETAIL

1/2" = 1'-0"

329341

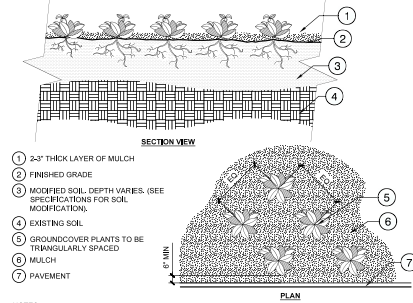

NOTES:

1- SEE PLANTING LEGEND FOR GROUND COVER SPECIES, SIZE, AND SPACING DIMENSION.

2- SMALL ROOTS (1/4" OR LESS) THAT GROW AROUND, UP, OR DOWN THE ROOT BALL PERIPHERY ARE CONSIDERED A NORMAL CONDITION IN CONTAINER PRODUCTION AND ARE ACCEPTABLE HOWEVER THEY SHOULD BE ELIMINATED AT THE TIME OF PLANTING. ROOTS ON THE PERIPHERY CAN BE REMOVED AT THE TIME OF PLANTING. (SEE ROOT BALL SHAVING CONTAINER DETAIL)

3- SETTLE SOIL AROUND ROOT BALL OF EACH GROUND COVER PRIOR TO MULCHING.

UNLESS NOTED OTHERWISE © 2012 CROWNED EARTH, INC. ALL RIGHTS RESERVED. NOT TO BE USED

5 GROUND COVER

3/4" = 1'-0"

FX-PLNT-FX-GROU01

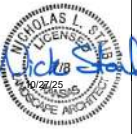

Kansas Code Plans LLC.
2827 N Beacon Hill Ct
Wichita, KS 67220
T 316.393.8576
KansasCodePlans.com

SOLOMON'S PORCH
ASSISTED LIVING
16550 WINDIAN CREEK PKWY.
OLATHE, KS 66062

PRINTS ISSUED
10/27/25 FOR APPLICATION

REVS.
NO. DATE DESC.

SLA No. drawn: NS
25-2005 checked: NS
PLANTING NOTES AND DETAILS

SLA
STUDIO
Landscape Architecture

316-304-1720

L103

© copyright 2019 Kansas Code Plans LLC.

Tree Survey

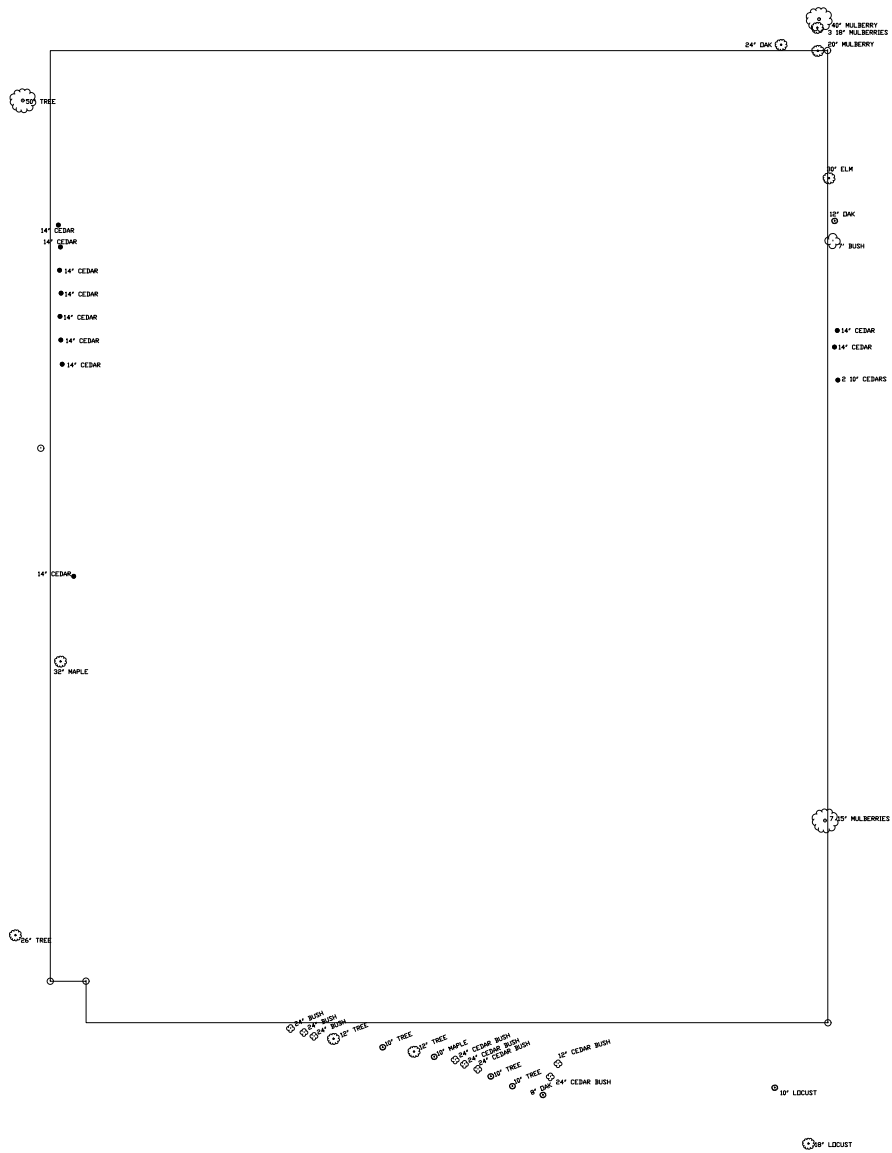
[illegible]

NOTES:

NO EXISTING SIGNIFICANT TREES IDENTIFIED ON THE TREE SURVEY
WILL BE REMOVED DURING THE CONSTRUCTION OF THE PRIVATE
INFRASTRUCTURE.

THE EXISTING TREES WERE DETERMINED TO BE 8 INCHES OR GREATER IN CALIPER AS MEASURED AT 4-1/2 FEET ABOVE THE GROUND.

HOWEVER, BASED ON THE SITES REQUIRED PLANTINGS, WE BELIEVE THAT WE HAVE MEANT THE MITIGATION FOR THE REMOVED TREES.

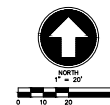

Prepared By: Payne & Brockway Engineers, P.A.
P. O. Box 128
Olathe, Kansas 66051
913-782-4800

Prepared For: McKinzie Asset Management Company LLC
c/o Mark McKinzie, Manager
12248 W. 128th Street
Overland Park, Kansas 66213
913-888-1000

Developed By: Insite Real Estates Investment
Properties LLC
c/o Andrew Johnson, P.E., P.M.
1400 Sixteenth Street, Suite #300
Oak Brook, Illinois 60523
847-287-9292

Date Prepared: November 15, 2024

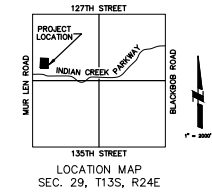

25-0002

Payne & Brockway P.A.
CIVIL ENGINEERS & LAND SURVEYORS
426 SOUTH KANSAS AVE. OLATHE, KANSAS 66061
PH: 913-782-4800 FAX: 913-782-0907
WWW.PAYNE-BROCKWAY.COM



SOLOMONS PORCH
INDIAN CREEK PKWY & SOUTH MUR-LEN RD
EXISTING TREE SURVEY EXHIBIT

EXHIBIT 10-1		
NO.	DATE	DESCRIPTION
1		
2		
3		
4		
5		
6		
7		

10/27/25

TREE SRV