

March 28, 2019

City of Olathe, Kansas  
Plan Review Comment Responses

Saddlewood Apartments – Building Façade Material Percentages

Please use the table and key plans below for the percentage of materials by individual building for the Saddlewood Apartments development in Olathe, Kansas.

BUILDING 'A' MATERIAL PERCENTAGES						
ELEVATION	TOTAL MATERIAL S.F.	MATERIAL - STONE	MATERIAL - SIDING	MATERIAL - GLASS	PERCENTAGE CATEGORY 1	PERCENTAGE CATEGORY 2
ELEVATION 1	2,670 S.F.	1,071 S.F.	767 S.F.	832 S.F.	71%	29%
ELEVATION 2	4,901 S.F.	1,781 S.F.	1,399 S.F.	1,721 S.F.	71%	29%
ELEVATION 3	2,422 S.F.	670 S.F.	596 S.F.	1,156 S.F.	75%	25%
ELEVATION 4	3,902 S.F.	1,469 S.F.	910 S.F.	1,523 S.F.	77%	23%
ELEVATION 5	2,427 S.F.	707 S.F.	679 S.F.	1,041 S.F.	72%	28%
ELEVATION 6	2,950 S.F.	1,373 S.F.	751 S.F.	826 S.F.	75%	25%
ELEVATION 7	4,615 S.F.	1,656 S.F.	1,395 S.F.	1,564 S.F.	70%	30%
ELEVATION 8	5,145 S.F.	1,446 S.F.	1,526 S.F.	2,173 S.F.	70%	30%
ELEVATION 9	3,171 S.F.	867 S.F.	938 S.F.	1,366 S.F.	70%	30%
ELEVATION 10	2,950 S.F.	1,373 S.F.	751 S.F.	826 S.F.	75%	25%
ELEVATION 11	6,902 S.F.	2,402 S.F.	1,964 S.F.	2,536 S.F.	72%	28%
ELEVATION 12	3,241 S.F.	1,470 S.F.	703 S.F.	1,068 S.F.	78%	22%
OVERALL BUILDING PERCENTAGES					73%	27%

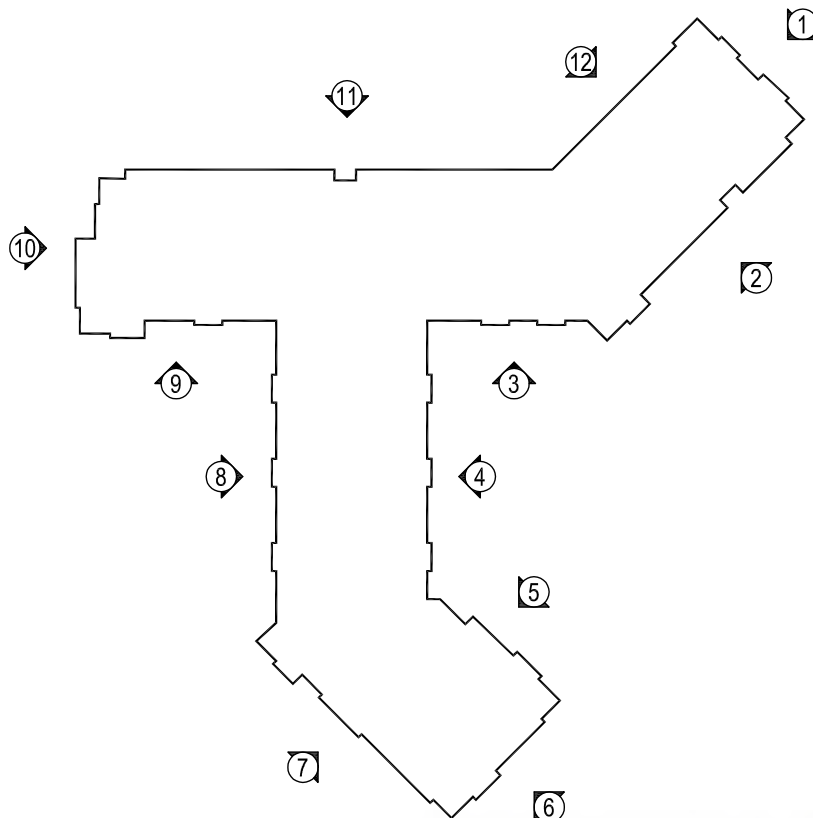

BUILDING 'B' MATERIAL PERCENTAGES						
ELEVATION	TOTAL MATERIAL S.F.	MATERIAL - STONE	MATERIAL - SIDING	MATERIAL - GLASS	PERCENTAGE CATEGORY 1	PERCENTAGE CATEGORY 2
ELEVATION 1	1,958 S.F.	821 S.F.	511 S.F.	626 S.F.	74%	26%
ELEVATION 2	3,646 S.F.	1,584 S.F.	1,055 S.F.	1,007 S.F.	71%	29%
ELEVATION 3	2,052 S.F.	856 S.F.	548 S.F.	648 S.F.	73%	27%
ELEVATION 4	5,471 S.F.	2,196 S.F.	1,649 S.F.	1,626 S.F.	70%	30%
ELEVATION 5	1,958 S.F.	821 S.F.	511 S.F.	626 S.F.	74%	26%
ELEVATION 6	7,418 S.F.	2,670 S.F.	2,226 S.F.	2,522 S.F.	70%	30%
ELEVATION 7	5,403 S.F.	1,723 S.F.	1,645 S.F.	2,035 S.F.	70%	30%
ELEVATION 8	4,562 S.F.	1,570 S.F.	1,247 S.F.	1,745 S.F.	73%	27%
OVERALL BUILDING PERCENTAGES					71%	29%

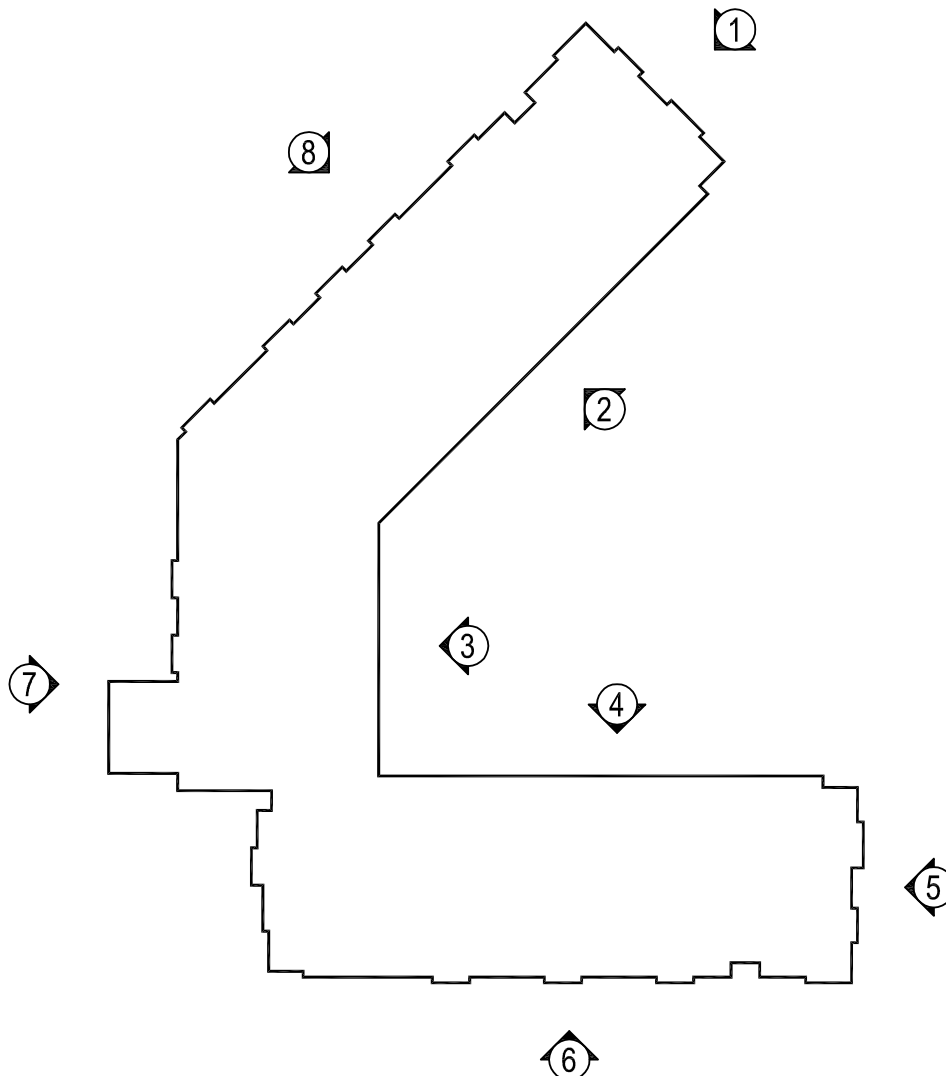

### BUILDING 'C' MATERIAL PERCENTAGES

ELEVATION	TOTAL MATERIAL S.F.	MATERIAL - STONE	MATERIAL - SIDING	MATERIAL - GLASS	PERCENTAGE CATEGORY 1	PERCENTAGE CATEGORY 2
ELEVATION 1	2,670 S.F.	1,071 S.F.	767 S.F.	832 S.F.	71%	29%
ELEVATION 2	7,811 S.F.	2,887 S.F.	2,042 S.F.	2,882 S.F.	74%	26%
ELEVATION 3	1,852 S.F.	570 S.F.	544 S.F.	783 S.F.	71%	29%
ELEVATION 4	4,965 S.F.	1,436 S.F.	1,418 S.F.	2,111 S.F.	71%	29%
ELEVATION 5	11,608 S.F.	3,616 S.F.	3,528 S.F.	4,464 S.F.	70%	30%
ELEVATION 6	2,198 S.F.	550 S.F.	550 S.F.	708 S.F.	75%	25%
ELEVATION 7	2,670 S.F.	1,071 S.F.	767 S.F.	832 S.F.	71%	29%
ELEVATION 8	3,545 S.F.	1,556 S.F.	989 S.F.	1,000 S.F.	72%	28%
ELEVATION 9	9,751 S.F.	3,533 S.F.	2,579 S.F.	3,639 S.F.	74%	26%
ELEVATION 10	2,769 S.F.	917 S.F.	691 S.F.	1,161 S.F.	75%	25%
ELEVATION 11	5,681 S.F.	1,683 S.F.	1,683 S.F.	1,909 S.F.	70%	30%
OVERALL BUILDING PERCENTAGES					72%	28%

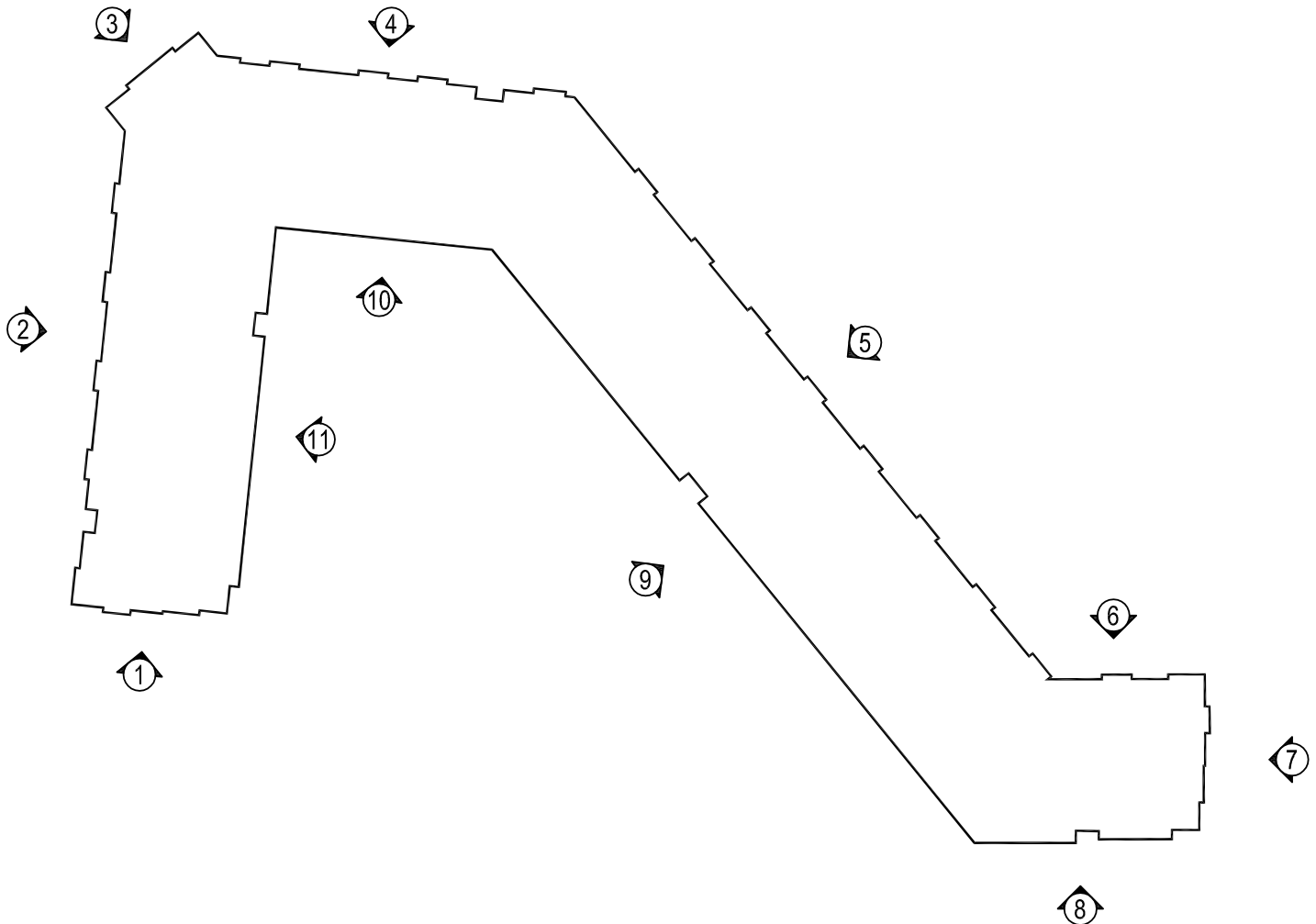

BUILDING 'D' MATERIAL PERCENTAGES						
ELEVATION	TOTAL MATERIAL S.F.	MATERIAL - STONE	MATERIAL - SIDING	MATERIAL - GLASS	PERCENTAGE CATEGORY 1	PERCENTAGE CATEGORY 2
ELEVATION 1	6,923 S.F.	2,526 S.F.	2,088 S.F.	2,309 S.F.	70%	30%
ELEVATION 2	10,904 S.F.	3,675 S.F.	3,313 S.F.	3,916 S.F.	70%	30%
ELEVATION 3	5,514 S.F.	2,126 S.F.	1,679 S.F.	1,709 S.F.	70%	30%
ELEVATION 4	2,234 S.F.	722 S.F.	680 S.F.	832 S.F.	70%	30%
ELEVATION 5	2,507 S.F.	807 S.F.	726 S.F.	974 S.F.	71%	29%
ELEVATION 6	4,544 S.F.	1,775 S.F.	893 S.F.	1,876 S.F.	80%	20%
ELEVATION 7	3,368 S.F.	1,275 S.F.	944 S.F.	1,149 S.F.	72%	28%
ELEVATION 8	2,234 S.F.	722 S.F.	680 S.F.	832 S.F.	70%	30%
OVERALL BUILDING PERCENTAGES					71%	29%

