

FINAL PLAT OF
FULLER'S GREYSTONE LAKE
A REPLAT OF LOTS 2 AND 3, GREYSTONE LAKE
PART OF THE NORTHEAST QUARTER OF SECTION 3, TOWNSHIP 14, RANGE 24
OLATHE, JOHNSON COUNTY, KANSAS

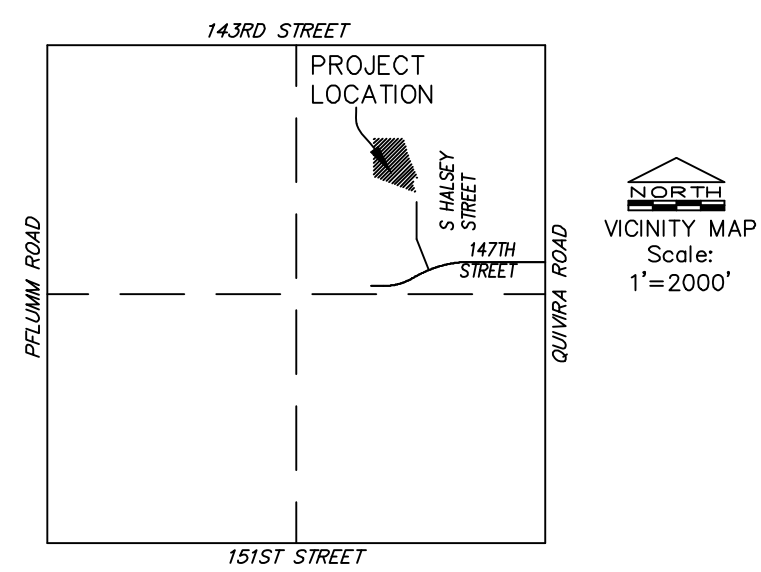

OWNER: Robert Reed and Sherryl J. Fuller
14632 S. Halsey Street
Olathe, KS. 66062

PROPERTY LOCATION: 14632 and 14636 S. HALSEY STREET

LEGAL DESCRIPTIONS:

This is a Resurvey and Replat of Lots 2 and 3, GREYSTONE LAKE, a subdivision in the City of Olathe, Johnson County, Kansas containing 2.02 acres.

The undersigned proprietors of the above tracts of land has caused the same to be subdivided in the manner shown on the accompanying plat, which subdivision and plat shall hereafter be known as "Fuller's Greystone Lake".

DEDICATION:

The undersigned proprietors of the above described tracts of land hereby agree and consent that the Board of County Commissioners of Johnson County, Kansas, and the City of Olathe, Johnson County, Kansas, shall have the power to release such land proposed to be dedicated for public ways and thoroughfares, or parts thereof, for public use, from the lien and effect of any special assessments, and that the amount of unpaid special assessments on such land dedicated, shall remain a lien on the remainder of this land fronting and abutting on said dedicated public way or thoroughfare.

CONSENT TO LEVY:

The undersigned proprietors of the above described tracts of land hereby agree and consent that the Board of County Commissioners of Johnson County, Kansas, and the City of Olathe, Johnson County, Kansas, shall have the power to release such land proposed to be dedicated for public ways and thoroughfares, or parts thereof, for public use, from the lien and effect of any special assessment, and that the amount of unpaid special assessments on such land so dedicated, shall become and remain a lien on the remainder of this land fronting or abutting on such dedicated public way or thoroughfare.

EXECUTION:

IN TESTIMONY WHEREOF, undersigned proprietors have caused this instrument to be executed on this ____ day of _____, 20 ____.

Robert Reed and Sherryl J. Fuller

By: _____
Robert Reed Fuller

By: _____
Sherryl J. Fuller

ACKNOWLEDGMENT

STATE OF KANSAS)
COUNTY OF JOHNSON) SS

BE IT REMEMBERED that on this ____ day of _____, 20 ____, before me, the undersigned, a Notary Public in and for said County and State, come Robert Reed and Sherryl J. Fuller, who are personally known to me to be such persons who executed the within instrument.

IN WITNESS WHEREOF, I have hereunto set my hand and affixed my official seal the day and year last above written.

Notary Public: _____ My Appointment Expires: _____

Print Name: _____

APPROVALS

Approved by the Planning Commission of the City of Olathe, Johnson County, Kansas, this ____ day of _____, 20 ____.

Chairman: Dean Vakas

Surveyor's Notes:

- Subject property is not located in the 100 Year Floodplain, per FEMA Map #20091C0096G dated 08.03.2009.
- Bearings are based upon the recorded plat of "GREYSTONE LAKE", all bearings, distances and curve data shown hereon are measured and match said Recorded Plat distances and geometry.



SCALE: 1" = 30'
DATE: 09/19/2016
Rev Drawing 7/10/18
Replat 8/13/19

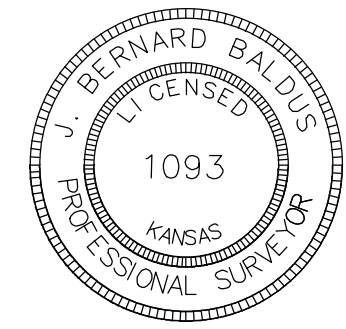

J. BERNARD BALDUS, KSPS # 1093

This is to certify that I have this day made a survey of the premises herein described and that the results are accurately recorded on the following plat:

LAND SURVEY COMPANY

A DIVISION OF HIGAR ENTERPRISES, INC.
6 OF A LICENSE NO. LS-79
Quality since 1999
P.O. BOX 528, GRANDVIEW, MISSOURI 64030
PHONE: (816) 966-0839 FAX: (816) 763-1761

