

LANDSCAPE LEGEND:

PER SECTION 18.30.130 OF THE OLATHE UDO

ALL TREES INCLUDED, BUT NOT LIMITED TO:

- COLUMNAR HORNSBEAM
- CRIMSON SPIRE OAK
- RED OAK
- WHITE OAK
- PRAIRIE GOLD ASPEN
- COLUMNAR WHITE PINE
- BLUE SPRUCE
- NORWAY SPRUCE
- CRABAPPLE TREES
- ORNAMENTAL MAGNOLIA

- DECIDUOUS / STREET / SHADE / TREE \ TOTAL = 39
- ORNAMENTAL TREE \ TOTAL = 21
- EVERGREEN TOTAL = 14
- SHRUB TOTAL = 109

NATIVE VEGETATION 3,510 s.f.

LANDSCAPE CALCULATIONS:

PER SECTION 18.30.130 OF THE OLATHE UDO, THE FOLLOWING IS REQUIRED:

MINIMUM STREET TREE REQUIREMENTS:

STREET TREES: ONE TREE PER 40' OF PUBLIC OR PRIVATE STREET FRONTAGE
- WARWICK STREET = 522 L.F. / 40 = 13 STREET TREES REQUIRED / 13 STREET TREES PROVIDED

MINIMUM PERIMETER LANDSCAPE REQUIREMENTS:

- A LANDSCAPE MIX OF SHRUBS, TREES AND OTHER PLANTINGS TO CREATE A VISUAL SCREEN OF THE PARKING AND VEHICULAR USE AREA. TREES SHOULD BE SPACED WITH AT LEAST ONE (1) TREE PER THIRTY (30) LINEAR FEET OF LANDSCAPE STRIP, WITH A WIDTH OF AT LEAST TEN (10) FEET; = 522 L.F. / 30 = 17 TREES REQUIRED + SHRUBS / 17 TREES PROVIDED + SHRUBS

INTERNAL PARKING LOT LANDSCAPE AREAS:

- ONE TREE PER ISLAND, (EACH ISLAND WILL BE LANDSCAPED APPROPRIATELY WITH GROUND COVER AND OR SHRUBS)

LANDSCAPE NOTES:

- LANDSCAPE NOTES SHALL APPLY TO ALL LANDSCAPE DRAWINGS.
- LOCATION OF ALL UTILITIES ARE APPROXIMATE. THE CONTRACTOR SHALL FIELD VERIFY LOCATIONS PRIOR TO COMMENCEMENT OF CONSTRUCTION OPERATIONS.
- LIMITS OF CONSTRUCTION ARE THE PROPERTY LINES. UNLESS OTHERWISE NOTED ON THE PLANS, EXCEPT WHERE ACCESS BEYOND IS REQUIRED FOR CONSTRUCTION RELATED TO UTILITY INSTALLATION AND EQUIPMENT ACCESS TO THE SITE.
- REFER TO CIVIL DRAWINGS FOR ALL GRADING AND BERMING, EROSION CONTROL, STORM DRAINAGE, UTILITIES AND SITE LAYOUT.
- THE CONTRACTOR SHALL ARRANGE AND CONDUCT A PRE-CONSTRUCTION MEETING ONSITE WITH LANDSCAPE ARCHITECT PRIOR TO ALL WORK.
- PLANT QUANTITIES ARE FOR INFORMATION ONLY. DRAWING SHALL PREVAIL IF CONFLICT OCCURS. CONTRACTOR IS RESPONSIBLE FOR CALCULATING OWN QUANTITIES AND BID ACCORDINGLY.
- THE CONTRACTOR IS TO NOTIFY LANDSCAPE ARCHITECT AFTER STAKING IS COMPLETED AND BEFORE PLANT PITS ARE EXCAVATED.
- THE CONTRACTOR SHALL PLACE SHREDDED HARDWOOD BARK MULCH AROUND ALL TREES TO A DEPTH OF 3", AND IN ALL PLANTING BEDS TO A DEPTH OF 2". WALNUT PRODUCTS ARE PROHIBITED.
- TREE LOCATIONS IN AREAS ADJACENT TO DRIVES, WALKS, WALLS AND LIGHT FIXTURES MAY BE FIELD ADJUSTED AS APPROVED BY THE LANDSCAPE ARCHITECT.
- KIND, SIZE AND QUALITY OF PLANT MATERIAL SHALL CONFORM TO AMERICAN STANDARD FOR NURSERY STOCK, ANS-260-2004, OR MOST RECENT EDITION.
- THE CONTRACTOR SHALL REPORT SUBSURFACE SOIL OR DRAINAGE PROBLEMS TO THE LANDSCAPE ARCHITECT.
- THE PLAN IS SUBJECT TO CHANGES BASED ON PLANT SIZE AND MATERIAL AVAILABILITY. ALL CHANGES OR SUBSTITUTIONS MUST BE APPROVED BY THE CITY OF OLATHE KANSAS AND THE LANDSCAPE ARCHITECT.
- PLANTING OF TREES, SHRUBS, SODDED AND SEEDED TURFGRASS SHALL BE COMMENCED DURING EITHER THE SPRING (APRIL 15-JUNE 15) OR FALL (SEPTEMBER 1-NOVEMBER 15) PLANTING SEASON AND WITH WATER AVAILABLE FOR IRRIGATION PURPOSES.
- STEEL EDGING TO BE USED ON ALL LANDSCAPE BEDS ABUTTING SODDED AREAS.
- LANDSCAPE CONTRACTOR IS TO BE RESPONSIBLE FOR WATERING ALL PLANT MATERIALS UNTIL THE TIME THE PERMANENT IRRIGATION SYSTEM IS FULLY FUNCTIONAL AND ACCEPTANCE OF THE PROJECT HAS TAKEN PLACE. ANY MATERIAL WHICH DIES, DEFOLIATES (PRIOR TO ACCEPTANCE OF THE WORK) WILL BE PROMPTLY REMOVED AND REPLACE.
- THE CONTRACTOR SHALL SHOW PROOF OF PROCUREMENT, SOURCES, QUANTITIES AND VARIETIES FOR ALL SHRUBS, PERENNIALS, ORNAMENTAL GRASSES AND ANNUALS WITHIN 21 DAYS FOLLOWING THE AWARD OF THE CONTRACT.
- ALL TREES SHALL BE CALLIPERED AND UNDERSIZED TREES SHALL BE REJECTED. ALL PLANT MATERIAL SHALL BE NURSERY GROWN, SOUND, HEALTHY, VIGOROUS AND FREE FROM INSECTS, DISEASE AND INJURIES, WITH HABIT OF GROWTH THAT IS NORMAL FOR THE SPECIES. SIZES SHALL BE EQUAL TO OR EXCEEDING SIZES INDICATED ON THE PLANT LIST. THE CONTRACTOR SHALL SUPPLY PLANTS IN QUANTITY AS SHOWN ON THE DRAWINGS.
- STAKE OR PLACE ALL PLANTS IN FIELD AS INDICATED ON THE DRAWINGS OR AS DIRECTED BY THE LANDSCAPE ARCHITECT FOR APPROVAL BY THE OWNER PRIOR TO PLANTING.
- ALL DISTURBED AREAS, INCLUDING RIGHTS OF WAY, NOT OTHERWISE COVERED BY BUILDING, PAVEMENT AND LANDSCAPE BEDS SHALL BE SODDED WITH TURF TYPE TALL FESCUE AND IRRIGATED UNLESS OTHERWISE INDICATED BY THE OWNER.
- ALL EXTERIOR GROUND MOUNTED OR BUILDING MOUNTED EQUIPMENT INCLUDING, BUT NOT LIMITED TO, MECHANICAL EQUIPMENT, UTILITIES' METER BANKS AND COOLERS MUST BE SCREENED FROM PUBLIC VIEW WITH THREE-SIDED LANDSCAPING OR AND ARCHITECTURAL TREATMENT COMPATIBLE WITH THE BUILDING ARCHITECTURE.
- PREPARE PLANTING BEDS BY INCORPORATING AN APPROVED COMPOSTED ORGANIC SOIL INTO EXISTING SOIL FOR ALL SHRUB, PERENNIAL AND ANNUAL PLANTING BEDS AT A MINIMUM DEPTH OF 6". THOROUGHLY MIX ORGANIC MATERIAL INTO THE EXISTING SOIL BY ROTOTILLING OR OTHER APPROVED METHOD TO A MINIMUM DEPTH OF 12".
- APPLY A COMMERCIAL ROOT STIMULATOR (APPROVED BY LANDSCAPE ARCHITECT PRIOR TO USE) TO ALL SHRUBS AND GROUND COVERS AT RATES RECOMMENDED BY MANUFACTURER DURING FIRST PLANT WATERING FOLLOWING INSTALLATION.
- ALL LANDSCAPE AREAS SHALL BE IRRIGATED WITH A HIGH EFFICIENCY AUTOMATIC IRRIGATION SYSTEM ACHIEVING 100% EVEN COVERAGE OF ALL LANDSCAPE AREAS. IRRIGATION SYSTEM SHALL BE DESIGN-BUILD TO MEET ALL CITY REQUIREMENTS.
- IN THE EVENT OF WORK IN OR ON THE JCW SANITARY MAIN, ANY TREES OR PLANTINGS PLACED WITHIN THE SEWER EASEMENT MAY BE REMOVED WITHOUT REPLACEMENT OR COMPENSATION THERE-OF AND SHALL BE REPLACED BY THE PROPERTY OWNER AS REQUIRED BY THE CITY.
- LANDSCAPE ADJACENT TO THE FIRE DEPARTMENT CONNECTION AND FIRE HYDRANT SHALL ALLOW FOR UNOBSTRUCTED VISIBILITY AND ACCESS, WITH NO SHRUBS OR TREES WITH IN A 3' RADIUS OF THE FIRE DEPARTMENT CONNECTION OR FIRE HYDRANT.

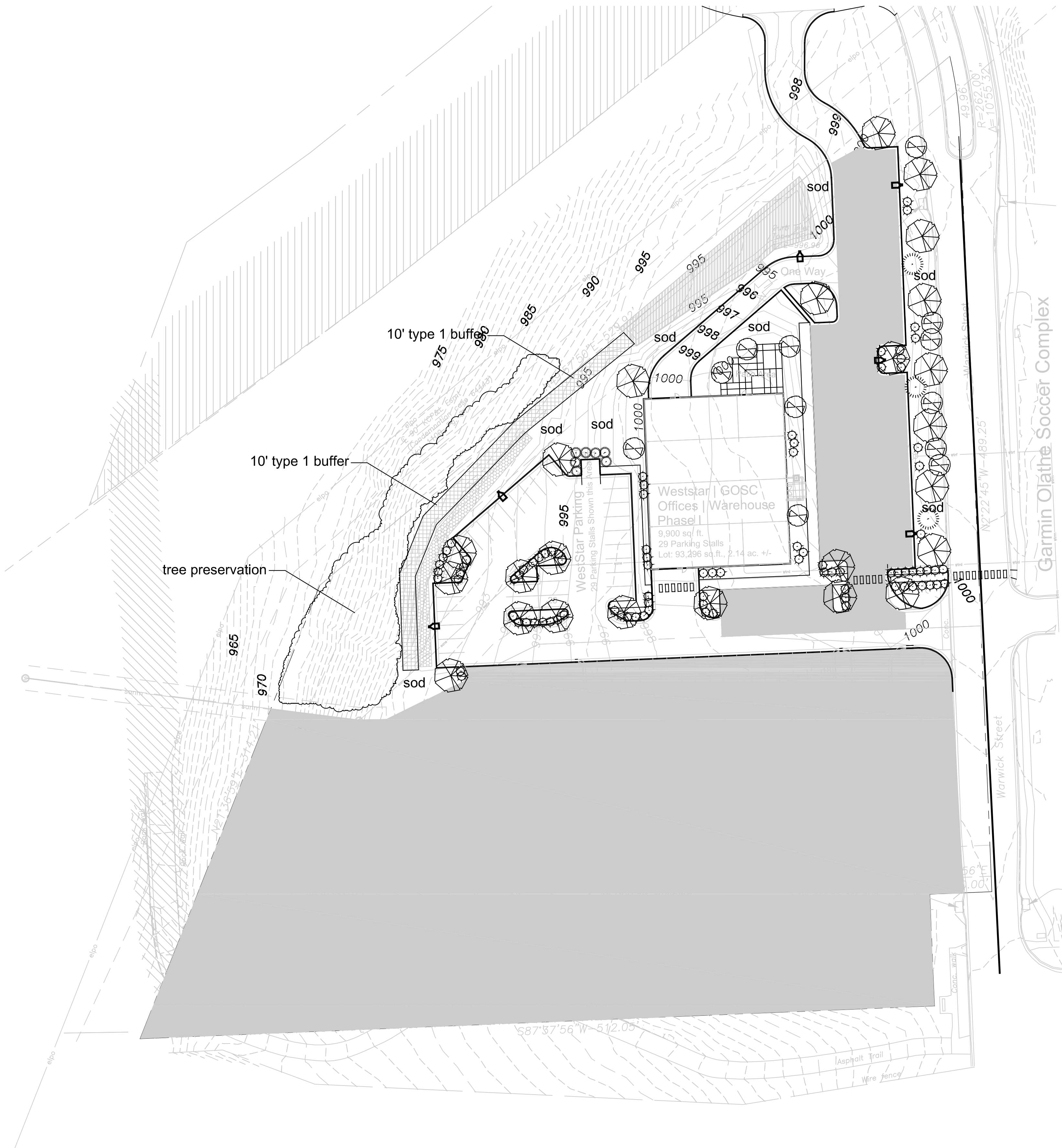

Curb Inlet
Top=1001.15
E W=995.90 18" CMP
E E=991.05 24" CMP

Curb Inlet (Full of Silt)
Top=997.03
E W=992.43 24" CMP

1 | Landscape Plan
scale: 1" = 40'-0"



4301 Indian Creek Parkway
Overland Park, KS 66207
phone: 913.451.8990
fax: 913.451.8991
www.davidsonae.com



landscape architecture • planning
prairie village, kansas
office - 913.424.8311
kvog1@verdigrismidwest.com

a proposed revised preliminary development plan for:
Lot 6, Olathe Soccer Complex
10568 S. Warwick Street
Olathe, Kansas

date
01.30.2020
drawn by
KLV
checked by
VSM
revisions
03.02.2020

1

sheet number

L1.1

drawing type
preliminary
project number
19027